

MODEL 245A

ADJUSTABLE 2" LOUVER
with Standard Blades

Office: (780) 485-5535
Facsimilie: (780) 485-5156

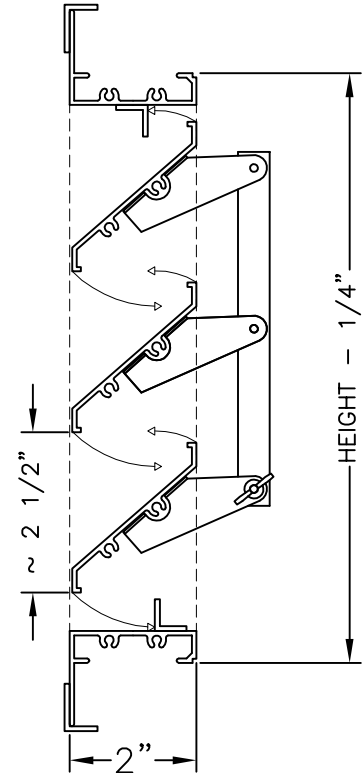
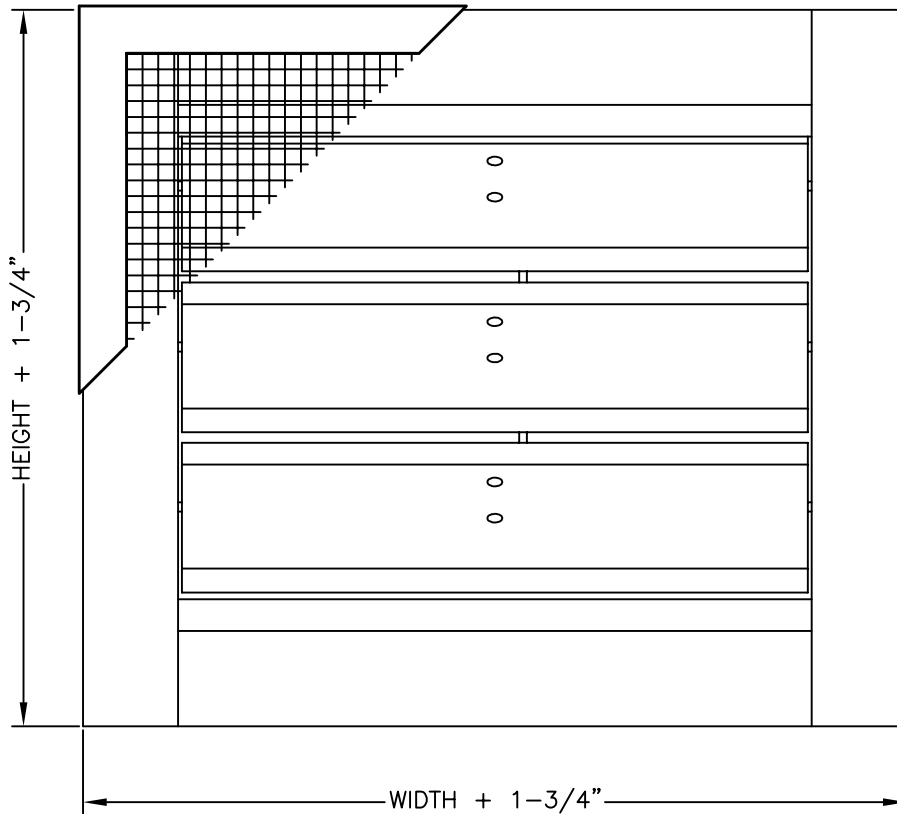

FLANGE FRAME 245AF (shown)

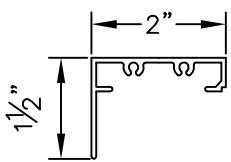

CHANNEL FRAME 245AC

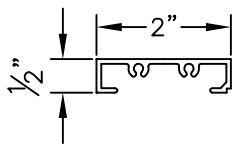

SPECIFICATIONS

FRAME	EXTRUDED ALUMINUM CHANNEL .070" THICKNESS.
BLADES	EXTRUDED ALUMINUM .070". LINKED AND ADJUSTABLE.
CONSTRUCTION	ASSEMBLED WITH CADMIUM PLATED STEEL SCREWS.
LOCKING DEVICE	WINGNUT (shown) SPRING AND CHAIN OPTIONAL
AXLES	CADMIUM PLATED STEEL SCREWS.
BIRDSCREEN	GALVANIZED SQUARE MESH FASTENED ON OUTSIDE FACE. 1/4" X 1/4" STANDARD 1/2" X 1/2" OPTIONAL 1" X 1" OPTIONAL
SIZE	MAXIMUM 48" IN WIDTH, MULTIPLE SECTIONS MADE OF EQUAL SIZES.

QTY.	WALL OPENING		LOUVER SIZE	
	WIDTH	HEIGHT	WIDTH	HEIGHT

PROJECT	
DATE	
ENGINEER	
CONTRACTOR	FILE #
SUPPLIER	DWG. #